

H.264 36x Outdoor Speed Dome Internet Camera

ICA-H652

Quick Installation Guide









Version 1.0

Table of Contents

Verify The Contents Inside Package Box	3
Physical Installation	4
Further Configuration	12

VERIFY THE CONTENTS INSIDE PACKAGE BOX

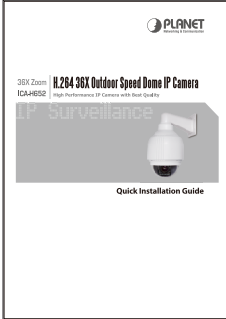
The package should contain the below items. If any item is missing or damaged, please contact the seller immediately.

		
<p>Dome Camera with Outdoor Mount Kit</p>	<p>Compact Pendant Mount</p>	<p>Data Cable</p>
		
<p>Waterproof Rubber</p>	<p>Dome Cover</p>	<p>Bracket screws kit</p>
		
<p>Security Tool</p>	<p>Lubricant</p>	<p>M3/M5 Standard Screw M3/M5 Security Screw</p>
		
<p>Quick Installation Guide</p>	<p>CD-ROM</p>	<p>AC Power Adapter</p>

Physical Installation



Caution

1. During the installation, please take care and avoid crash. That may cause the device damage or cause injury of the installer.
2. Please make sure the hardware had been located on the wall properly. If the hardware drops down, it is possible make someone injury or hurt. Please check the hardware again after the installation.
3. Please according to the practical local power voltage to adjust the power switch. The wrong input voltage may cause the device damage.

Step 1

Unpack the Dome Camera's package and take out the Dome Camera unit.



Step 2

Rotate the Outdoor Mount Kit, and take it off from the camera body.



Step 3

Attach the dome cover to the camera body. Before doing that, apply some lubricant on the cover's water-proof rubber to make the installation process smoother.



Note

The tiny protrusion on the dome cover must align with one of the four holes on the dome body.

Step 4

Gently pressure the dome cover downward with two hands on the side of it.

DO NOT press the cover, as shown in the figure; this might cause damage to the camera body.



Step 5

Use the M3 screw to screw the dome cover and camera body together.

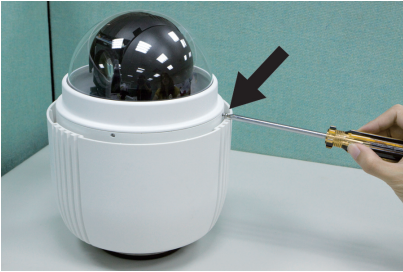

Step 6

Make a cable entry hole on the wall to recess the cables. Otherwise, users could push up the Cable Entry Board on the Compact Pendant Mount's Mounting Plate to place the cables, as shown in the photo below.

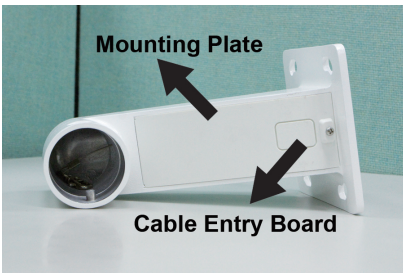

Step 7

Fix the Compact Pendent Mount on the wall with proper screws and screw anchors.

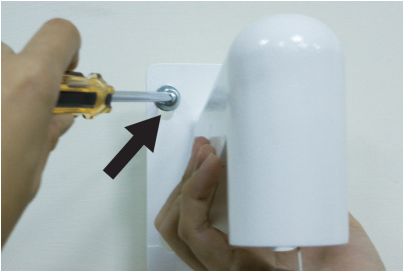

Note

The screws and screw anchors don't attach in package

Step 8

Attach the Waterproof Rubber to the Outdoor Wall Mount.



Step 9

Pass the network and data cables through the Compact Pendant Mount with the Data Cable's 22-pin cable coming out of the outlet.

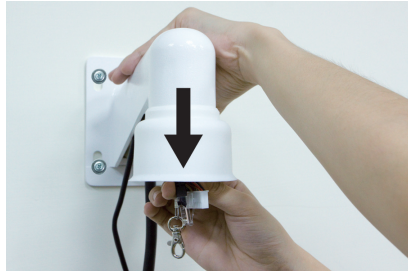
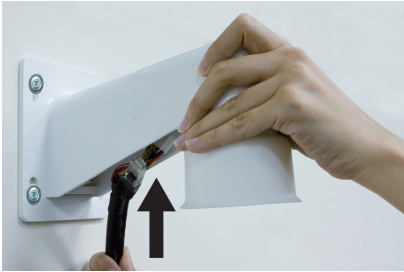

Note

1. The network cable doesn't attach in package
2. Please block the cable entry hole with the supplied sponge to avoid insects entering the Pendant Mount. The sponge can be placed in two ways as shown in the illustrations below.

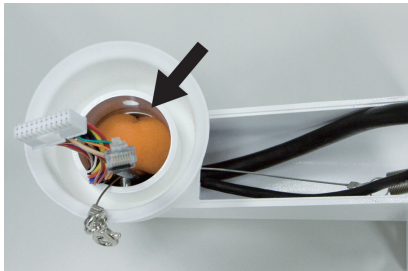
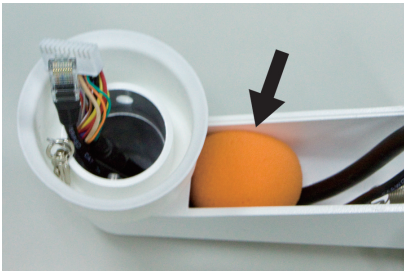

Step 10

Thread the cables through the Outdoor Mount Kit and join the Outdoor Mount Kit to the Compact Pendant Mount with the supplied screws and washers. Then adjust the Waterproof Rubber to the joint.

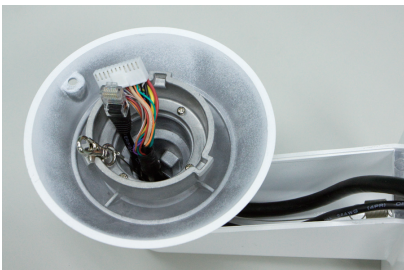

Step 11

Use the safety hook hanging the camera, and connect the cables to the Dome Camera.

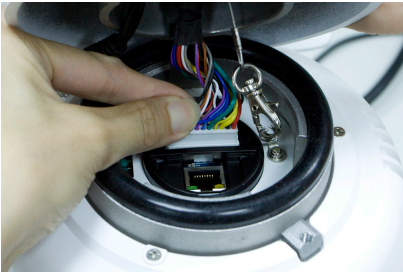

Step 12

Join the Dome Camera to the Outdoor Mount Kit with the supplied M5 screw and washers.

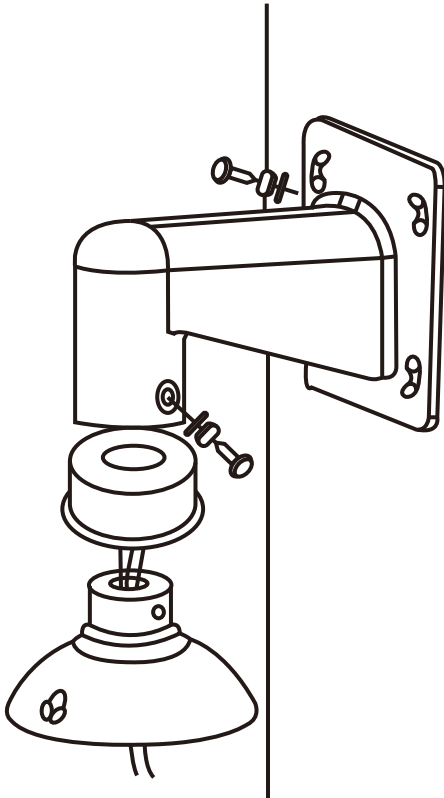

Step 13

Connecting the AC power adapter with Power Input connector of data cable.

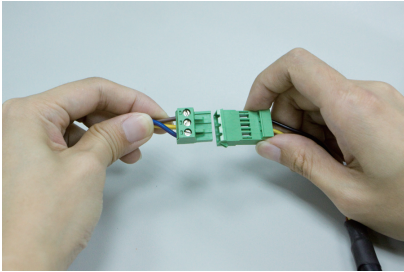

Then according to the practical local power voltage to adjust the power switch, and connect the power cord with adapter and power outlet.



Use only the power adapter shipped with the unit to ensure correct functionality

Note

Step 14

Connecting the network cable with switch.



Step 15

Set your computer's IP address to 192.168.0.x, where x is a number between 1 to 253 (except 20 where is being used for the camera by default). If you don't know how to do this, please ask your network administrator.

Step 16

Use web browser (Internet Explorer 6.0 or above) to connect to **192.168.0.20** (type this address in the address bar of web browser).

You'll be prompted to input user name and password: **admin** / null (without password).

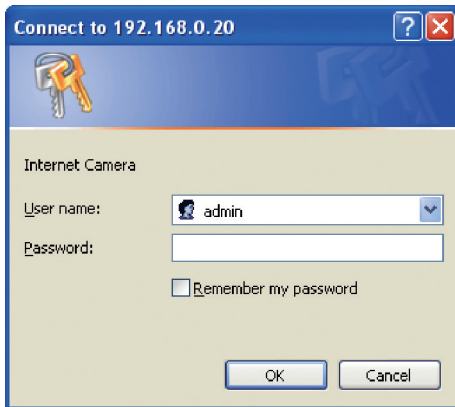

Further Configuration

For detail configuration, please check user's manual on the bundled CD.

If you have any other questions, please contact the dealer where you purchased this product or you can contact PLANET directly at the following

Email address: support_ica@planet.com.tw

www.planet.com.tw

PLANET Technology Corp.



36X Zoom
ICA-H652

H.264 36X Outdoor Speed Dome IP Camera

High Performance IP Camera with Best Quality



Quick Installation Guide