

## 8-Port Combo KVM over IP Switch



### Easily Control Servers with Flexibility

The PLANET 8-Port Combo IP KVM Switch, IKVM-8020 is an enterprise-class, secure, KVM-over-IP switch that provides BIOS-level control of up to 64 servers. Use a dedicated micro-controller and potentially specialized video capture hardware to capture the video, keyboard, and mouse signals, compress and convert them into packets, and send them over an Ethernet link to a remote console application that unpacks and reconstitutes the dynamic graphical image. This IP KVM solution includes standard features such as Powerful Mouse / Keyboard Support such as installing software, transferring files and backing up data.



### Powerful VGA / Mouse / Keyboard Support

The IKVM-8020 will detect the current video mode of the console automatically; and manual fine-tuning is also available to receive an optimal video quality. The IKVM-8020 will accept video streams with a dot clock rate up to 110MHz, therefore, the remote VGA resolution can up to 1600 x 1200 video resolution.

User can connect up to 8 PCs to the IKVM-8020. The IKVM-8020 also fully supports various models of PS/2 and USB mice manufactured by Logitech, Microsoft and IBM as well as compatible PS/2 and USB mice of other brands. The KVM supports the PS/2 and USB Keyboard port of the code set 1/2/3 and further allows you to use the KVM for all kinds of servers and PCs.

### Hardware

- 19" rack mount 1U size design
- LED display for easy status monitoring
- Cascade controls up to 64 computers from single console
- High Video Resolution up to 1920 x 1440 (local side) or 1600 x 1200 (remote side)
- Supports hot plug; no need to power off the KVM switch or PCs when adding or removing PCs

### System

- Supports SSL protocol for any encrypted network traffic between itself and a connected client
- Automatically senses video resolution for best possible screen capture
- No Software Required: easy PC selection via On Screen Display (OSD) menu, Push Buttons, Hot Keys
- Compliant with DOS, Windows, Netware, Unix, Linux, iMAC, Power MAC and Sun Micro Systems with USB port by connecting with a USB-PS/2 adapter

### Installation

- Remote mass storage control
- Supports password protection and PC server name search
- Buzzer sound for switching port confirmation
- Keyboard status restored when switching PCs

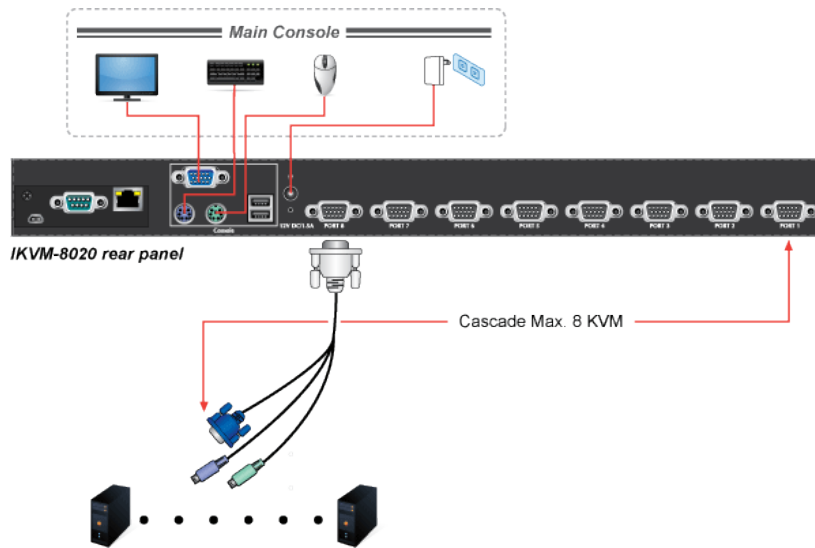

*Easy Switching , Efficient Management*

The IKVM-8020 can fully control the connected PCs of any platform through any at-hand browser or just work as a normal 16-Port KVM Switch in local site. By the support of daisy chain function, users can cascade one IKVM-8020 to multiple KVM-810 or KVM-1610, and manage this KVM chain with one single IP. The IKVM-8020 is the ideal choice for those users who want to maintain their PC system at office or home 24/7.

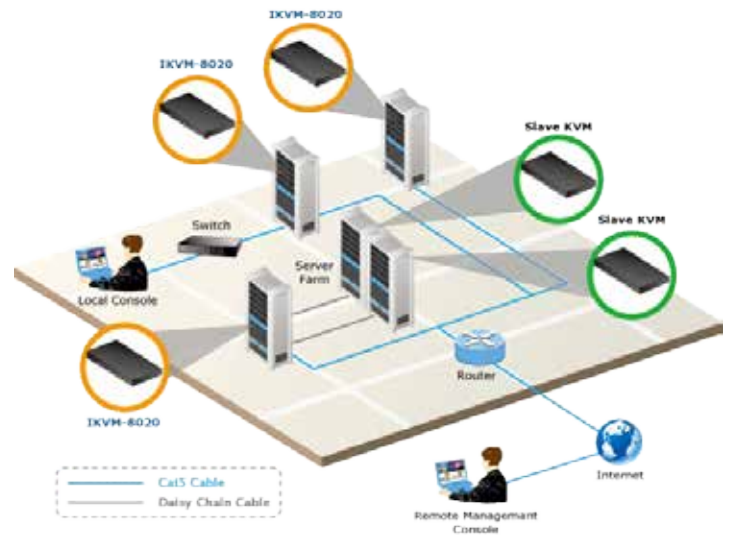

**Application**

*Remote management via network*

With PLANET IKVM-8020, network administrators can control a server room locally or remotely through Internet. No additional software or license fee is needed; multiple users can securely access remote server by using a standard web browser to create a HTTPS/SSL connection.

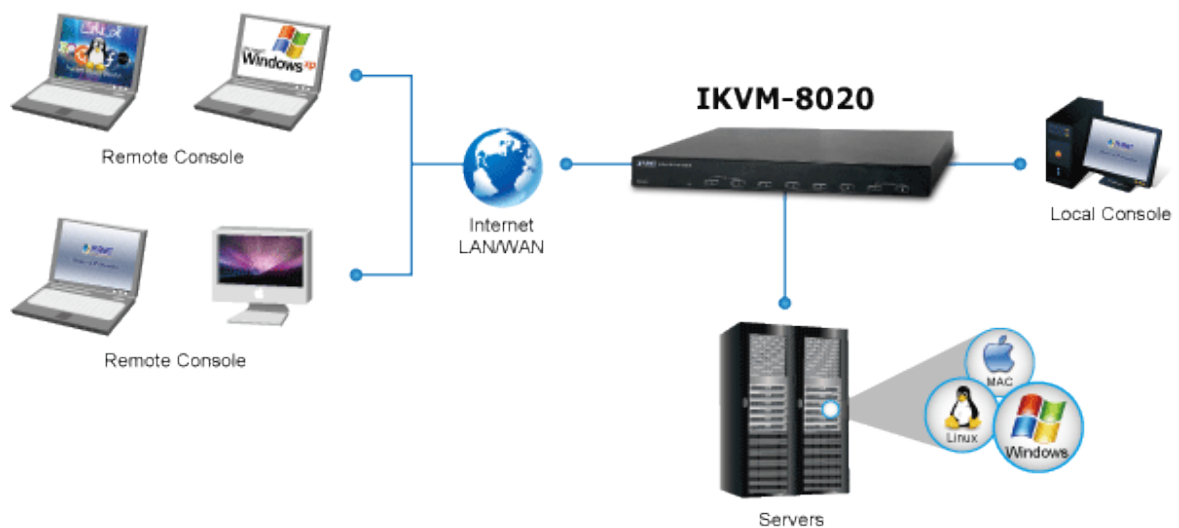

## Specification

Model	IKVM-8020
<b>Product Specification</b>	
PC Port	8
Host Connectors (all female type)	HDDB 15-pin x 8
Local Console Connectors (all female type)	USB keyboard port & USB mouse port PS/2 keyboard port & PS/2 mouse port HDDB 15-pin VGA port
Daisy Chain Connectors (all female type)	PS/2 keyboard port PS/2 mouse port HDDB 15-pin VGA port
Remote Console	Remote Console
<b>Control Feature</b>	
Max connected PCs	64 (by cascade 8 KVM-810)
Max cascade levels	2
Port Selection Keys	8
PC Selection	On Screen Display Menu / Hot Key / Button
VGA Resolution	Local console: 1920 x 1440 Remote console: 1600 x 1200
<b>Network and Configuration</b>	
Network Standard	IEEE 802.3 10Base-T IEEE 802.3u 100Base-TX
Supported Protocol	TCP, IP, ARP, ICMP, HTTP/HTTPS, Telnet, SSH, DHCP/BOOTP, PPP, SMTP, DNS, NTP, Dynamic DNS
Client Software	Microsoft Java VM, Sun Java VM (Plug in), Netscape Java VM
Remote Access Key	128-bit SSL / 256-bit SSL(Firefox)
Keyboard / mouse Emulation	USB & PS/2
DDC / EDID communication	DDC2
<b>Environment</b>	
Dimension (W x D x H)	160 x 444.5 x 44.3 mm
Weight	2.76kg
Environmental Specification	Operating temperature: 0 ~ 50 Degree C Storage temperature: -20 ~ 60 Degree C Relative humidity: 0 ~ 80% (non-condensing)
Power Requirement	12V DC, 1.5A
Electromagnetic Compatibility	FCC, CE

## Ordering Information

IKVM-8020	8-Port Combo KVM Over IP Switch
-----------	---------------------------------

## Related Information

KVM-810	8-Port Combo KVM Switch
KVM-1610	16-Port Combo KVM Switch

## Accessories

KVM-DCB-1.8	1.8 Meter 1-to-3 DKVM Combo Cable
KVM-DCB-3	3 Meter 1-to-3 DKVM Combo Cable
KVM-DCB-5	5 Meter 1-to-3 DKVM Combo Cable

### PLANET Technology Corporation

11F., No.96, Minquan Rd., Xindian Dist., New Taipei City  
231, Taiwan (R.O.C.)

Tel: 886-2-2219-9518

Email: [sales@planet.com.tw](mailto:sales@planet.com.tw)

Fax: 886-2-2219-9528

[www.planet.com.tw](http://www.planet.com.tw)



PLANET reserves the right to change specifications without prior notice. All brand names and trademarks are property of their respective owners. Copyright © 2013 PLANET Technology Corp. All rights reserved.

**IKVM-8020**